

# PREMIUM LIST

Early entries close on Wednesday, November 25, 2020 at 8pm  
Send entries to P.O. Box 720249, Pinon Hills, CA 92372  
Day of Entries Accepted until Limit is reached

## 45th Annual Turkey Run

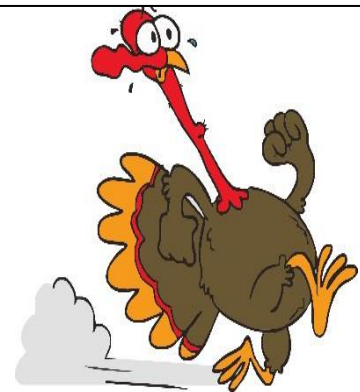

Incomplete, unsigned, conditional or unpaid entries will not be accepted.

### ALL SIGHTHOUND ASFA & AKC LURE COURSING TEST & TRIALS ENTRIES ARE LIMITED TO 50 HOUNDS

CCA & OCRRRC ARE LICENSED BY THE AKC

FRIDAY, NOVEMBER 27, 2020  
1 AKC TEST (Event #2020251411) and an Breed Trial

SATURDAY, NOVEMBER 28, 2020  
#2020281117

SUNDAY, NOVEMBER 29, 2020  
#2020251412

PRADO DOG TRAINING FACILITY  
17505 EUCLID AVENUE, CHINO, CA

Trial Pre-Entry Fee	\$20 for first hound \$17 for additional hounds, same owner
Test Pre-Entry Fee	\$15 per hound
Day Of Entry	<b>\$25</b>



Permission has been granted by The American Kennel Club for the holding of this event under American Kennel Club Rules and Regulations.

THE 44th ANNUAL TURKEY RUN  
Jennifer Gysler  
P.O. Box 720249  
Pinon Hills, CA 92372  
FIRST CLASS MAIL  
DATED MATERIAL

TRIALS ARE LIMITED TO 50 HOUNDS EACH DAY  
DAY OF ENTRIES WILL BE ACCEPTED UP UNTIL 8:30AM PROVIDED ENTRY LIMITS HAVE NOT BEEN REACHED  
COVID-19 PRECAUTIONS IN EFFECT MASKS AND SOCIAL DISTANCING REQUIRED PLEASE REVIEW & SIGN WAIVER  
NO FOOD WILL BE SERVED  
(TRIAL WILL BE ON THE "NEW" FIELD USED AT OCTOBER EVENT – there is very little shade. Please bring your own shade, water, food, crate for your dog, snacks etc.)

# 45th ANNUAL TURKEY

## TURKEY RUN FIELD COMMITTEE

Field Chairman: Scott Pack .....805-698-2310  
419 N Palm Ave, Santa Paula, CA

Field Secretary: Jennifer Gysler..... 818-400-4812  
P.O. Box 720249, CA 92372 jennifergysler@gmail.com

Lure Operators: Scott Pack, Hunter Smith,  
Keith Hicks



CALIFORNIA COURSING ASSOCIATION



## OFFICERS

President: John Skoglund                      Vice President: Susan Smith  
Secretary: Jennifer Gysler                      Treasurer: Scott Pack

Board of Directors: Linda D'Antonio, Annemarie Pack, Jennie Skoglund, Jane Taylor,  
Hunter Smith

## ORANGE COAST RHODESIAN RIDGEBACK CLUB

## OFFICERS

President: Jennifer Gysler                      Vice President: Jenny Cradle  
Cor. Secretary: Sherri West                      Rec. Secretary: Sandra Kirsch

Treasurer: Dorothy Crinion

Board of Directors: Lisa Adams, Sherrie Todd, Alex Gilewski

## PRE- ENTRY FEES AND PAYMENTS

MAIL ENTRIES to the Field Secretary's address above and make checks payable to "CCA" for all events. FAX ENTRIES will not be accepted. E-MAIL ENTRIES to [jennifergysler@gmail.com](mailto:jennifergysler@gmail.com). They will be accepted provided the Field Secretary receives payment before 8 pm on Wednesday, November 25, 2020 for pre-entries and the entry form is signed. If using PayPal, send to [socialcoursing@gmail.com](mailto:socialcoursing@gmail.com) and be sure to pay for your transaction fees. Do not defer the Pay Pal fees to the club or your entry will be declined.

# 45th ANNUAL TURKEY

## AKC ELIGIBILITY

Only purebred Afghan Hounds, Azawakhs\*, Basenjis, Borzoi, Cirnechi dell'Etna, Greyhounds, Ibizan Hounds, Irish Wolfhounds, Italian Greyhounds, Norrbottenspets\*, Peruvian Inca Orchid\*, Pharaoh Hounds, Portuguese Podengos\*, Portuguese Podengo Pequenos, Rhodesian Ridgebacks, Salukis, Scottish Deerhounds, Sloughis\*, Thai Ridgebacks\* and Whippets that are one year of age or older and have been registered with the American Kennel Club, the AKC Foundation Stock Service, an AKC recognized foreign registry or that have been granted an Indefinite Listing Privilege (ILP) may be entered. \*FSS breeds compete for suffix titles—no championship points awarded.

## FRIDAY – 1 AKC LURE COURSING TEST [2:00pm]

**JC TEST RUNS:** Open to all hounds of an eligible breed. A hound, at least 12 months of age, running alone shall receive a certification from a Judge on one date and a second certification from a different Judge at a later date, stating that the hound completed a 600 yard course with a minimum of four (4) turns. The hound must complete the course with enthusiasm and without interruption.

**QC TEST RUNS:** Open to all hounds of an eligible breed. A hound at least 12 months of age (Qualifying Hound) running with another hound of the same breed or another breed with a similar running style (Partner Hound) shall receive certification from a licensed judge, stating that the hound completed a 600 yard course with a minimum of four (4) turns. The hound must complete the course with enthusiasm and without interruption. **The handler presenting the Qualifying Hound shall be responsible for providing the Partner Hound for the test. It is recommended that every Qualifying Hound practice with other hounds prior to being presented for a QC test.**

## FRIDAY – ASFA LURE COURSING TRIAL STAKES [9:00AM]

**OPEN STAKE:** Open to any eligible sighthound excluding ASFA Field Champions of record, that has met certification requirements.

**FIELD CHAMPION STAKE:** Open to any ASFA Field Champion.

**OPEN VETERAN STAKE:** Open to any eligible sighthound whose age is over 6 years, except Irish Wolfhounds whose age shall be at least 5 years and Whippets, Rhodesian Ridgebacks, Salukis and Afghan Hounds whose age shall exceed 7 years on the day of the trial. Points and placements go towards the V-FCh and V-LCM titles.

**SINGLE STAKE:** Open to any eligible sighthound including those disqualified to run in other stakes. They are not eligible for Best of Breed or Best in Field. Hounds are eligible to earn TCP and CPX titles from the Singles Stake. Limited breeds are not eligible for these titles. Hounds will run alone.

**LURE COURSING INSTINCT STAKES:** Open to all Non-Sighthounds and Sighthound mixes: **Small Open** for dogs 17 ½ inches or less at the withers and/or brachycephalic ("flat-faced") dogs who have not achieved the title of LCC. **Small Senior** for dogs 17 ½ inches or less at the withers or brachycephalic ("flat-faced") dogs who have achieved the title of LCC. **Small Veteran** for dogs 17 ½ inches or less at the withers and/or brachycephalic dogs over the age of 7 years. **Large Open** for dogs over 17 ½ inches at the withers who have not achieved the title of LCC. **Large Senior** for dogs over 17 ½ inches at the withers who have achieved the title of LCC. **Large Veteran** for dogs over 17 ½ inches at the withers who are over the age of 7 years. **Sighthound mix Open** for dogs with a sighthound breed in its background who have not achieved the title of LCC. **Sighthound mix Senior** for dogs with sighthound breed in its background who have achieved the title of LCC. **Sighthound mix Veteran** for dogs with sighthound breed in its background over the age of 7 years. When running as a stake within a regular ASFA trial, small will run 50% of the ASFA course as laid out for the sighthounds up to a maximum of 400 yards. All other stakes will run the full ASFA laid out course length.

# 45th ANNUAL TURKEY

## JUDGES AND ASSIGNMENTS

Faith Burnham West Valley City, Utah (AKC Sat & Sun)  
 Linda D'Antonio Redlands, CA (Asfa Fri & Sat)  
 Mike Savage Spokane, WA (Asfa & AKC Fri, Sat & Sun)  
 Hunter Smith El Cajon, CA (AKC test, & AKC Sat & Sun)

FRI.-ASFATrial AKC Test 11/27	Jc/Qc	A	B	B	C	G	I	I	I	P	R	S	S	S	W	LCI	Sgl
		A	A	O			B	W	G			A	D	W			
Mike		S	S	S	S	S	S	S	X	X	S	X	S	X	X	S	S
Linda D.									X	X		*		*	X		
Hunter	X																

SATURDAY 11/28 – AKC	A	B	B	C	G	I	I	I	P	P	R	S	S	W	FSS	Sgl
	A	O			B	W	G		Q			A	D			
Faith					X		X	X	X	X	X	X	X			
Mike	X	X	X	X	X	X	X	X		X	X	X	X	X		
Hunter	X	X	X	X	X		X		X					X	X	
SUNDAY 11/29 - AKC	A	B	B	C	G	I	I	I	P	P	R	S	S	W	FSS	Sgl
	A	O			B	W	G		Q			A	D			
Faith	X	X	X	X		X	X		X		X		X	X	X	X
Mike			X	X	X	X	X	X	X	X	X	X	X	X		
Hunter	X	X			X			X		X		X				

## TIMES

**TRIAL HOURS:** 7:30 am (facility opens) until completion

**FRIDAY ROLL CALL:** ASFA Trial 9:00am; AKC Test 2:00pm

**SATURDAY & SUNDAY ROLL CALL:** Trials, 8:30am

*All exhibitors must be present for Roll Call*

**INSPECTION:** Immediately follows Roll Call with early Inspection available

**DRAW:** Immediately follows Inspection

## RIBBONS AND TROPHIES

**1<sup>st</sup> place:** Blue ribbon  
**2<sup>nd</sup> place:** Red ribbon  
**3<sup>rd</sup> place:** Yellow ribbon  
**4<sup>th</sup> place:** White ribbon  
**5<sup>th</sup> place:** Pink ribbon

**Junior Courser/Qualified Courser:** Green ribbon

**Best of Breed:** Purple and Gold rosette, plush toys

**High Scoring Single:** Navy and Gold rosette, plush toys

**Best in Field:** Red, White and Blue rosette, club prize

**Continuum Breed Winner:** Specialty rosette, plush toy, cool trophy

**Continuum Best of the Best:** Tri Color sash, Metal Engraved Trophy on Wooden Base with mystery contents

**New Field Champion:** Medal given by SoCal Coursing

**Greyhound breed winners:** Medallion sponsored by Greyhound Club of America with special award for Greyhound TR Continuum breed winner

**Saluki stake winners:** Medallion sponsored by Saluki Club of America

# 45th ANNUAL TURKEY

## CONTINUUM COMPETITION – SPECIAL NEW TROPHIES THIS YEAR!!

-----BEST OF THE BEST-----



### RULES TO THE COMPETITION:

- Hounds must run all three (3) days to be eligible: Friday, Saturday, and Sunday.
- Hounds must have a qualifying score each day to continue in the competition.
- Points are earned by the number of dogs defeated according to raw scores within each breed, plus 1. Tie scores earn ½ dog defeated.
- Points are earned regardless of whether each individual hound within the breed is eligible for the competition or not.
- The highest point total from the three (3) days will determine the Continuum Breed Winner. In case of a tie, the placement will be run off or forfeited.
- At the conclusion of Sunday's Best In Field run, the Continuum Best of the Best run-off will take place. Each of the Continuum Breed winners will have the opportunity to run in this event. This run may be forfeited by eligible participants, but there must be a minimum of two (2) hounds running for the Best of the Best.

### 2019 Turkey Run Continuum Best

of the Best

*Whippet*

*FC Belaya R.L SeaHawk SC DCAT MC FCh LCX CA*

*"Charlie"*

# 45th ANNUAL TURKEY

## SATURDAY & SUNDAY - AKC LURE COURSING TRIAL[8:30am]

**OPEN STAKE:** Open to hounds that have obtained an AKC Qualified Courser Certificate, an ASFA Field Champion title, or a CKC Field Champion title. Hounds that have earned an AKC Field Champion title are not eligible to enter the Open Stake.

**SPECIAL STAKE:** Open to hounds that have earned their AKC Field Champion title.

**OPEN VETERAN STAKE:** Open to hounds that are eligible to enter the Open or Special Stakes and have reached 6 years of age on the day of the trial, except Irish Wolfhounds at 5 years of age, and Afghan Hounds, Rhodesian Ridgebacks, Salukis, and Whippets at 7 years of age.

**SINGLE STAKE:** Open to hounds including those disqualified to run in other stakes.

*\* Best In Field will be offered; however, Portuguese Podengo Pequenos, and FSS breeds are ineligible to compete for BIF.*

## ENTRY INFORMATION

1. Hounds not present at the time of roll call will be scratched after a 5 minute grace period.
2. Each entry will be examined at inspection for breed disqualifications.
3. Bitches in season, hounds with breed disqualifications (except for the Single Stake) and lame hounds will be excused and have their entry fees refunded.
4. Spayed and neutered hounds, without breed disqualifications, may be entered.
5. Monorchid and cryptorchidhounds are ineligible to participate.

## OPERATIONAL INFORMATION

1. All hounds will run twice, in trios, if possible, or braces unless excused, dismissed or disqualified.
2. Each course will be reversed for the final runs and again for Best of Breed but the Best in Field running direction shall be determined by the judge(s).
3. Gasoline powered continuous loop lure machines will be used. The lures will consist of plastic strips. Backup equipment will be available.

## GENERAL INFORMATION

1. Please bring your own food, shade and water.
2. A restroom will be available.
3. No one, except Field Committee members, will be allowed on the field without the expressed permission of the Field Committee.
4. A \$5 fine will be assessed for loose hounds during courses in progress.
5. Anyone failing to clean up their dogs' waste will be excused from the field for the day.
6. Anyone exhibiting unsportsmanlike conduct will be excused from the field for the day.
7. CCA and OCRRC assume no liability for injury to any person or dog before, during or after the Tests and Trials.

# 45th ANNUAL TURKEY

## DIRECTIONS

**From Orange County:** Take the 55 North to the 91 East. Next, merge onto the 71 North. Then, take the Butterfield Ranch Road/Euclid Avenue (CA-83) exit. Turn right and the facility will be located on the right side 1/10 of a mile down Euclid Avenue.

**From the Inland Empire:** Take the 91 West onto the 71 North. Exit Butterfield Ranch Road/Euclid Avenue (CA-83) and make a right. The facility will be located on the right side 1/10 of a mile down Euclid Avenue.

**From San Gabriel Valley:** Take the 210 East to the 57 South. Then, transition on the 71 South towards Corona. Take the Butterfield Ranch Road/Euclid Avenue (CA-83) exit and turn left. The facility will be located on the right side 1/3 of a mile down Euclid Avenue.

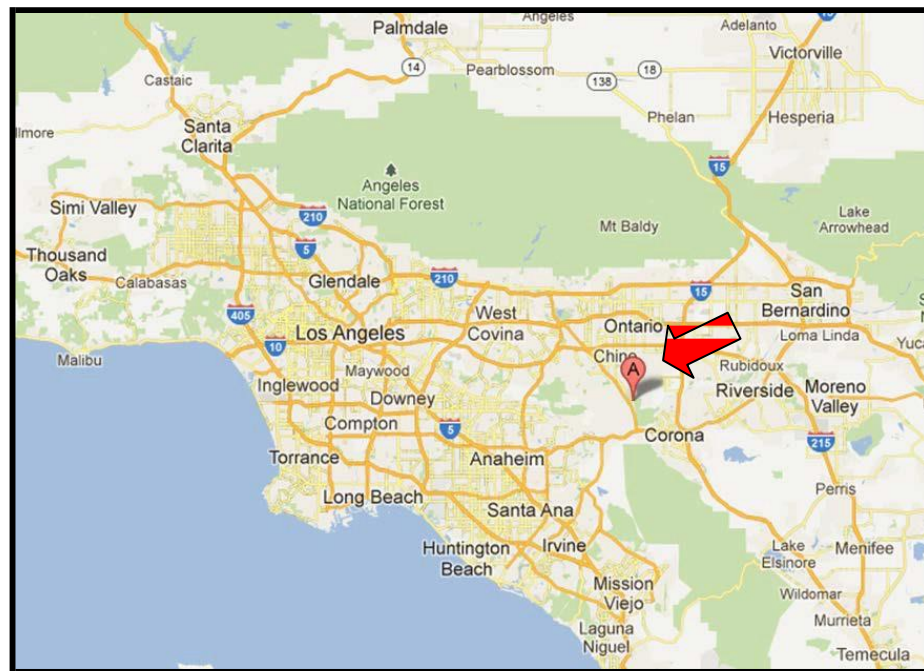

## PARK ADMISSION - IMPORTANT

*Entry to the park is \$15 per person or per married couple, which includes up to 2 dogs. Each additional dog is \$3, children under 16 are free.*

**\*\*\* The CCA and OCRRC do not agree to arbitrate claims as set forth on the official American Kennel Club entry form for this event.**

# 45th ANNUAL TURKEY

## PRACTICE

Will be available both Friday and Saturday if weather, equipment and daylight permit. Practice is \$2 per dog/run. The exact time they will take place depends on the flow of the Trial.



## VETERINARIAN

Yorba Regional Animal Hospital . . . . . 714-921-8700  
8290 E. Crystal Drive, Anaheim, CA 92807

Head south on S Euclid Ave. Turn slight right to merge onto CA-71 S. Keep right at the fork, follow signs for California 91 W/Beach Cities and merge onto CA-91 W. Take exit 39 for Weir Canyon Rd/Yorba Linda Blvd. Turn right onto Yorba Linda Blvd. Take the 1st right onto Savi Ranch Pkwy. Take the 1st left onto Crystal Dr.

## HOSPITAL

Chino Valley Medical Center . . . . . 909-464-8600  
5451 Walnut Avenue, Chino, CA 91710

Head south on S Euclid Ave. Turn left to merge onto CA-71 N. Take exit 7 for Central Ave toward Soquel Canyon Pkwy. Turn right onto Central Ave. Turn right onto Walnut Ave.

## MOTELS

La Quinta Inn & Suites	Motel 6	Ayres Suites Corona West
3555 Inland Empire Blvd	231 North Vineyard Ave	1900 W Frontage Rd
Ontario, CA	Ontario, CA	Corona, CA
909-476-1112	909-937-6000	951-738-9113

## CAMPING

Overnight camping is permitted at the facility for an additional \$15 per night.

### Alternative Site

Prado Regional Park . . . . . 909-597-4260  
16700 Euclid Avenue, Chino, CA 91708

Camping fees include \$7 non-refundable camping reservation fee with \$35 per unit per night which includes hook-ups.

Head north on S Euclid Ave. approximately 1 mile. Destination will be on the right.

# 45th ANNUAL TURKEY

## FIELD AND COURSE PLANS

Average High: 70°  
Field Surface: Mowed natural field  
Fencing: Natural borders only, no direct fencing

**FRIDAY: 630 yards**

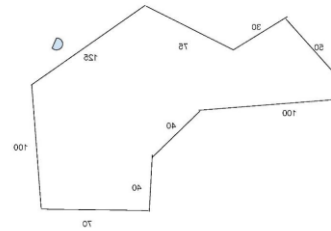

**SATURDAY: 605 yards**

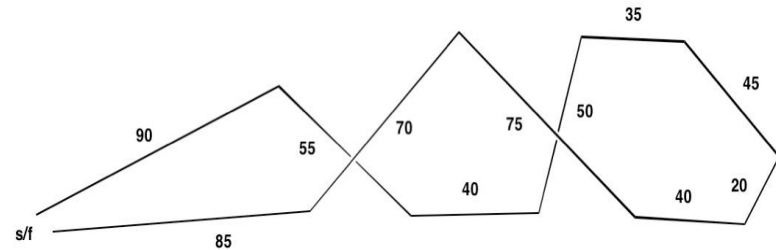

**SUNDAY: 720 yards**

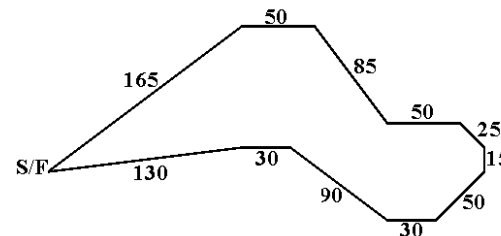

*CCA & OCRRC reserve the right to alter course plans as necessary.*

OFFICIAL AMERICAN SIGHTHOUND FIELD ASSOCIATION ENTRY FORM

CALIFORNIA COURSING ASSOCIATION

FRIDAY NOV 27, 2020

Early entries close on NOV 25, 2020 at 8pm at FTS' residence

Early entries: \$20 1st hound, \$17 2nd hound; Late Entry Fee \$25

Make checks payable in US funds to California Coursing Association

JENNIFER GYSLER, FTS, PO Box 720249, Pinon Hills, CA 92372

Fee Paid \_\_\_\_\_ The Field Secretary cannot accept conditional, unsigned, incomplete or unpaid entries; please check your completed entry carefully.

Breed:	Call Name:		
Registered Name of Hound:			
Stake: <input type="checkbox"/> Open <input type="checkbox"/> FCH <input type="checkbox"/> Veteran <input type="checkbox"/> Single <input type="checkbox"/> Limited	Additional Stakes <input type="checkbox"/> Kennel <input type="checkbox"/> Breeder <input type="checkbox"/> Bench		
<b>Registration Number:</b> (please write in registering body before number)			
Name of actual owner(s):			
Address:		Phone:	
City:	State:	Zip:	
E-mail (Optional)		(Optional) Region of Residence:	
Emergency Name Contact and Phone Number (optional)			
<input type="checkbox"/> <b>Check if this is the first ASFA trial for this hound. Attach a Hound Certification or waiver if entered in Open, Veterans, Limited.</b>			
<input type="checkbox"/> <b>Check if this is a first-time entry, a copy of the official Registration of this hound must accompany this entry unless NGA.</b>			
<input type="checkbox"/> Check if any information has changed since the last ASFA trial entry. Regarding _____			
<input type="checkbox"/> Check if this hound has been dismissed within the last 6 trials entered. Must be marked in order to qualify for a "clean" trial requirement.			

I CERTIFY that I am the actual owner of this dog, or that I am the duly authorized agent of the actual owner whose name I have entered above. In consideration of the acceptance of this entry and the opportunity to have this dog judged and to win prize money, ribbons, or trophies, I (we) agree to abide by the rules and regulations of the American Sighthound Field Association in effect at the time of this lure field trial, and by any additional rules and regulations appearing in the premium list for this lure field trial. I (we) agree that the club holding this lure field trial has the right to refuse this entry for cause, which the club shall deem to be sufficient. I (we) agree to hold this club, its members, directors, governors, officers, agents or other functionaries, any employees of the aforementioned parties and the owner(s) of the trial premises or grounds harmless from any claim for loss or injury which may be alleged to have been caused directly or indirectly to any person or thing by the act of this dog while in or upon the lure field trial premises or grounds or near any entrance thereto and I (we) personally assume all responsibility and liability for any

such claim, and I (we) further agree to hold the aforementioned parties harmless from any claim loss of this dog by disappearance, theft damage or injury be caused or alleged to be caused by the negligence of the club or any of the aforementioned parties or by the negligence of any person or any other cause or causes. I (we) certify and represent that the dog entered is not a hazard to person or other dogs. This entry is submitted for acceptance of the forgoing representations and agreements.

**SIGNATURE** of owner or his agent  
duly authorized to make this entry \_\_\_\_\_

AMERICAN SIGHTHOUND FIELD ASSOCIATION HOUND CERTIFICATION

**Rule effective October 1, 1994: Ch. V, Sec. 4 (a) OPEN STAKE:** *To be eligible to enter the open stake, a hound must have been certified by a licensed judge within the year preceding the closing date for the entry or have previously competed in the Open Stake. This eligibility requirement also applies to a hound entered in the Limited or Veteran Stake, which has not competed in Open previously. Please complete this portion of this form and attach it to the entry form for the hound's first entry, including an entry for a Fun Trial.*

Registered Name of Hound: \_\_\_\_\_

Registration Number: \_\_\_\_\_ Breed: \_\_\_\_\_

Registered Owner's Name: \_\_\_\_\_

I hereby certify that on (date) \_\_\_\_\_, the above named hound completed a lure course of at least 500 yards, running with another hound of the same breed (or another breed with a similar running style). During the course the above named hound showed no inclination to interfere with the other hound. I further certify that I am a licensed judge for the ASFA.

Name of Licensed Judge: \_\_\_\_\_

Signature: \_\_\_\_\_ Date: \_\_\_\_\_

I hereby certify that the hound running in the certification course is the hound identified above and that information provided on this form is true and correct.

Signature: \_\_\_\_\_ Date: \_\_\_\_\_  
Owner or Authorized Agent of Hound

This certification form must be attached to the entry form the first time this hound is entered in an open, limited, or veteran stake. Any hound entered in open, limited, or veteran (as a first time entered hound), which has not been certified, shall be declared ineligible by the records coordinator and shall forfeit any points and placements awarded.

**PLEASE RETAIN A COPY FOR YOUR RECORDS.**

**AMERICAN SIGHTHOUND FIELD ASSOCIATION  
HOUND CERTIFICATION WAIVER**

**Waiver of Requirement:** *This requirement will be waived for a hound that has earned a lure coursing or racing title from another recognized organization, if such title requires competition, and if a waiver for such title has been approved by the ASFA, or a CKC Hound Certification Form. If your hound qualifies for a waiver, complete this portion of this form and attach it to your entry form. Proof of waivers must accompany this certification form.*

Registered Name of Hound: \_\_\_\_\_

Registration Number: \_\_\_\_\_ Breed: \_\_\_\_\_

Registered Owner's Name: \_\_\_\_\_

**CKC:** FCH

**AKC:** QC SC

Hound Certification previously submitted.

I hereby certify that the hound identified above has completed the requirements for the title indicated above (or that the required Certification was previously submitted) and that the information provided on this form is true and correct.

Signature: \_\_\_\_\_ Date: \_\_\_\_\_  
Owner or Authorized Agent of Hound



## Las Vegas Lure Coursing 50/50

- ♥ You may enter any sighthound you own or have owned
- ♠ Entry is \$2/dog
- ♣ Sign up at Roll Call to 10 am
- ♦ Breeds are not split into multiple stakes
- ♥ Two judges start with scores of 30
- ♠ At signup two cards are drawn from a standard deck—these are your preliminary scores
- ♣ Ace to ten are face value, Jacks-11, Queens-12, Kings-13 and a Joker is an excusal (e.g. drawing a 7 and King would equate to a 37 and an 43)
- ♦ During lunch break the second group of cards is drawn for the finals
- ♥ All scores are tallied to determine BOB winners
- ♠ Any ties are determined by a “draw off”
- ♣ BOB winners will then draw for Best In Field whereby the BIF winner and the Club split the proceeds 50/50

## OFFICIAL AMERICAN KENNEL CLUB LURE COURSING ENTRY FORM

Club: <b>CALIFORNIA COURSING ASSOCIATION</b>		Date: <b>FRI 11/27/20</b>	Event #s: <b>2020251411</b>	
Location: <b>CHINO, CA</b>		Event type (test or trial) <b>TEST ONLY</b>		
Stakes: <input type="checkbox"/> JC Test <input type="checkbox"/> QC Test		Breed:	I enclose entry fees in the amount of: \$	
Breeder:	AKC # <input type="checkbox"/>	PAL# <input type="checkbox"/>	Foreign # & List Country: <input type="checkbox"/>	Date of Birth:
Call Name of Dog:	Registration #:			Sex:
Full Name of Dog:				
Sire:				
Dam:				
Actual Owner(s):				
Owner's Address:				
City:			State:	Zip Code:
Name of Owner's Agent/Handler (if any) at Trial:				
<input type="checkbox"/> Please Separate My Entries.		<input type="checkbox"/> Hound Dismissed Within the Last 6 Trials.		
<p><b>AKC Rules, Regulations, Policies and Guidelines are available on the American Kennel Club website: <a href="http://www.akc.org">www.akc.org</a></b></p> <p><b>AGREEMENT</b></p> <p>I CERTIFY that I am the actual owner of this dog, or that I am the duly authorized agent of the actual owner whose name I have entered above. In consideration of the acceptance of this entry, I (we) agree to abide by the rules and regulation of The American Kennel Club in effect at the time of this trial, and by the rules and regulations appearing in the premium list for this trial, and entry for. I (we) certify and represent that the dog entered in not a hazard to persons or other dogs. The entry is submitted for acceptance on the foregoing representation and Agreement. I (we) agree that the club holding this event has the right to refuse this entry for cause which the club shall deem sufficient. In consideration of the acceptance of this entry and the holding of this event and of the opportunity to have the dog judged an to win prize money, ribbons, or trophies, I (we) agree to hold the AKC, the event giving club, their members, directors, governors, officers, agents superintendents or event secretary ant the owner or lessor of the premises and any provider of services that are necessary to hold this event and any employees or volunteers of the aforementioned parties, and any AKC approved judge, judging at this event, harmless from any claim for loss or injury which may me alleged to have been caused directly or indirectly to any person or thing by the act of this dog while in or about the event premises or grounds or near any entrance thereto, and I (we) person all assume all responsibility and liability for any such claim; and I (we) further agree to hold the aforementioned parties harmless from any claim for loss, injury or damage to this dog.</p> <p>Additionally, I (we) hereby assume the sole responsibility for and agree to indemnify, defend and save the aforementioned parties harmless from any and all loss and expense (including legal fees) by reason of the liability imposed by law upon any of the aforementioned parties for damage because of bodily injuries, including death at any time resulting therefrom, sustained by any person or persons, including myself (ourselves) or on account of damage to property, arising out of or in consequence of my (our) participation in this event, however such, injuries death or property damage may be caused, and whether or not the same may have been cause or may be alleged to have been cause by the negligence of the aforementioned parties or any of their employees, agents, or any other persons. I (WE) AGREE THAT ANY CAUSE OF ACTION, CONTROVERSY OR CLAIM ARISING OUT OF OR RELATED TO THE ENTRY, EXHIBITION OR ATTENDANCE AT THE EVENT BETWEEN THE AKC AND MYSELF (OURSELVES) OR AS TO THE CONTRUCTION, INTERPRETATION AND EFFECT OF THIS AGREEMENT SHALL BE SETTLED BY ARBITRATION PURSUANT TO THE APPLICABLE RULES OF THE AMERICAN ARBITRATION ASSOCIATION, HOWEVER, PRIOR TO ARBITRATION ALL APPLCABLE AKC BYLAWS, RULES, REGUALTIONS AND PROCEDURES MUST FIRST BE FOLLOWED AS SET FORTH IN THE AKC CHARTER AND BYLAWS, RULES, REGULATIONS, PUBLISHED POLICIES AND GUIDELINES.</p>				
Signature of owner or his agent duly authorized to make this entry _____				
Telephone:			Email address:	

## OFFICIAL AMERICAN KENNEL CLUB LURE COURSING ENTRY FORM

Club: <b>ORANGE COAST RHODESIAN RIDGEBACK CLUB</b>		Date: <b>SAT 11/28/20</b>	Event #: <b>2020281117</b>	
Location: <b>CHINO, CA</b>		Event type (test or trial) <input type="checkbox"/> Trial		
Stakes: <input type="checkbox"/> Open <input type="checkbox"/> Special <input type="checkbox"/> Veteran <input type="checkbox"/> Single		Breed:		I enclose entry fees in the amount of: \$
Breeder:	AKC # <input type="checkbox"/>	PAL# <input type="checkbox"/>	Foreign # & List Country: <input type="checkbox"/>	Date of Birth:
Call Name of Dog:	Registration #:		Sex:	
Full Name of Dog:				
Sire:				
Dam:				
Actual Owner(s):				
Owner's Address:				
City:		State:	Zip Code:	
Name of Owner's Agent/Handler (if any) at Trial:				
<input type="checkbox"/> Please Separate My Entries.		<input type="checkbox"/> Hound Dismissed Within the Last 6 Trials.		
<p><b>AKC Rules, Regulations, Policies and Guidelines are available on the American Kennel Club website: <a href="http://www.akc.org">www.akc.org</a></b> <b>AGREEMENT</b></p> <p>I CERTIFY that I am the actual owner of this dog, or that I am the duly authorized agent of the actual owner whose name I have entered above. In consideration of the acceptance of this entry, I (we) agree to abide by the rules and regulation of The American Kennel Club in effect at the time of this trial, and by the rules and regulations appearing in the premium list for this trial, and entry for. I (we) certify and represent that the dog entered in not a hazard to persons or other dogs. The entry is submitted for acceptance on the foregoing representation and Agreement. I (we) agree that the club holding this event has the right to refuse this entry for cause which the club shall deem sufficient. In consideration of the acceptance of this entry and the holding of this event and of the opportunity to have the dog judged an to win prize money, ribbons, or trophies, I (we) agree to hold the AKC, the event giving club, their members, directors, governors, officers, agents superintendents or event secretary ant the owner or lessor of the premises and any provider of services that are necessary to hold this event and any employees or volunteers of the aforementioned parties, and any AKC approved judge, judging at this event, harmless from any claim for loss or injury which may me alleged to have been caused directly or indirectly to any person or thing by the act of this dog while in or about the event premises or grounds or near any entrance thereto, and I (we) person all assume all responsibility and liability for any such claim; and I (we) further agree to hold the aforementioned parties harmless from any claim for loss, injury or damage to this dog.</p> <p>Additionally, I (we) hereby assume the sole responsibility for and agree to indemnify, defend and save the aforementioned parties harmless from any and all loss and expense (including legal fees) by reason of the liability imposed by law upon any of the aforementioned parties for damage because of bodily injuries, including death at any time resulting therefrom, sustained by any person or persons, including myself (ourselves) or on account of damage to property, arising out of or in consequence of my (our) participation in this event, however such, injuries death or property damage may be caused, and whether or not the same may have been cause or may be alleged to have been cause by the negligence of the aforementioned parties or any of their employees, agents, or any other persons. <b>I (WE) AGREE THAT ANY CAUSE OF ACTION, CONTROVERSY OR CLAIM ARISING OUT OF OR RELATED TO THE ENTRY, EXHIBITION OR ATTENDANCE AT THE EVENT BETWEEN THE AKC AND MYSELF (OURSELVES) OR AS TO THE CONTRUCTION, INTERPRETATION AND EFFECT OF THIS AGREEMENT SHALL BE SETTLED BY ARBITRATION PURSUANT TO THE APPLICABLE RULES OF THE AMERICAN ARBITRATION ASSOCIATION, HOWEVER, PRIOR TO ARBITRATION ALL APPLCABLE AKC BYLAWS, RULES, REGUALTIONS AND PROCEDURES MUST FIRST BE FOLLOWED AS SET FORTH IN THE AKC CHARTER AND BYLAWS, RULES, REGULATIONS, PUBLISHED POLICIES AND GUIDELINES.</b></p>				
Signature of owner or his agent duly authorized to make thisentry _____				
Telephone:		Email address:		

## OFFICIAL AMERICAN KENNEL CLUB LURE COURSING ENTRY FORM

Club: <b>CALIFORNIA COURSING ASSOCIATION</b>		Date: <b>SUN 11/29/20</b>	Event #: <b>2020251412</b>	
Location: <b>CHINO, CA</b>		Event type (test or trial) <input type="checkbox"/> Trial		
Stakes: <input type="checkbox"/> Open <input type="checkbox"/> Special <input type="checkbox"/> Veteran <input type="checkbox"/> Single		Breed:		I enclose entry fees in the amount of: \$
Breeder:	AKC # <input type="checkbox"/>	PAL# <input type="checkbox"/>	Foreign # & List Country: <input type="checkbox"/>	Date of Birth:
Call Name of Dog:	Registration #:		Sex:	
Full Name of Dog:				
Sire:				
Dam:				
Actual Owner(s):				
Owner's Address:				
City:		State:	Zip Code:	
Name of Owner's Agent/Handler (if any) at Trial:				
<input type="checkbox"/> Please Separate My Entries.		<input type="checkbox"/> Hound Dismissed Within the Last 6 Trials.		
<p><b>AKC Rules, Regulations, Policies and Guidelines are available on the American Kennel Club website: <a href="http://www.akc.org">www.akc.org</a></b> <b>AGREEMENT</b></p> <p>I CERTIFY that I am the actual owner of this dog, or that I am the duly authorized agent of the actual owner whose name I have entered above. In consideration of the acceptance of this entry, I (we) agree to abide by the rules and regulation of The American Kennel Club in effect at the time of this trial, and by the rules and regulations appearing in the premium list for this trial, and entry for. I (we) certify and represent that the dog entered in not a hazard to persons or other dogs. The entry is submitted for acceptance on the foregoing representation and Agreement. I (we) agree that the club holding this event has the right to refuse this entry for cause which the club shall deem sufficient. In consideration of the acceptance of this entry and the holding of this event and of the opportunity to have the dog judged an to win prize money, ribbons, or trophies, I (we) agree to hold the AKC, the event giving club, their members, directors, governors, officers, agents superintendents or event secretary ant the owner or lessor of the premises and any provider of services that are necessary to hold this event and any employees or volunteers of the aforementioned parties, and any AKC approved judge, judging at this event, harmless from any claim for loss or injury which may me alleged to have been caused directly or indirectly to any person or thing by the act of this dog while in or about the event premises or grounds or near any entrance thereto, and I (we) person all assume all responsibility and liability for any such claim; and I (we) further agree to hold the aforementioned parties harmless from any claim for loss, injury or damage to this dog.</p> <p>Additionally, I (we) hereby assume the sole responsibility for and agree to indemnify, defend and save the aforementioned parties harmless from any and all loss and expense (including legal fees) by reason of the liability imposed by law upon any of the aforementioned parties for damage because of bodily injuries, including death at any time resulting therefrom, sustained by any person or persons, including myself (ourselves) or on account of damage to property, arising out of or in consequence of my (our) participation in this event, however such, injuries death or property damage may be caused, and whether or not the same may have been cause or may be alleged to have been cause by the negligence of the aforementioned parties or any of their employees, agents, or any other persons. <b>I (WE) AGREE THAT ANY CAUSE OF ACTION, CONTROVERSY OR CLAIM ARISING OUT OF OR RELATED TO THE ENTRY, EXHIBITION OR ATTENDANCE AT THE EVENT BETWEEN THE AKC AND MYSELF (OURSELVES) OR AS TO THE CONTRUCTION, INTERPRETATION AND EFFECT OF THIS AGREEMENT SHALL BE SETTLED BY ARBITRATION PURSUANT TO THE APPLICABLE RULES OF THE AMERICAN ARBITRATION ASSOCIATION, HOWEVER, PRIOR TO ARBITRATION ALL APPLCABLE AKC BYLAWS, RULES, REGUALTIONS AND PROCEDURES MUST FIRST BE FOLLOWED AS SET FORTH IN THE AKC CHARTER AND BYLAWS, RULES, REGULATIONS, PUBLISHED POLICIES AND GUIDELINES.</b></p>				
Signature of owner or his agent duly authorized to make thisentry _____				
Telephone:		Email address:		



CCA / OCRRC COURSING COVID-19 EVENT WAIVER

I fully attest to the best of my knowledge that I do NOT have COVID-19 at the time of attending this event. I also attest that I have NOT been in contact with or exposed to any known carrier of COVID-19 within the past 14 days. I agree that I am attending this event entirely at my own risk and take full responsibility for my own health and safety during this event. I will follow all AKC and host club rules and requirements to reduce any exposure and possibility of contracting or spreading the virus. I will also fully cooperate with any city, county or state guidelines that have jurisdiction in the area in which the event is taking place.

I fully submit that the American Kennel Club (AKC), American Sighthound Field Association (ASFA), host clubs (CCA & OCRRC) and the venue that I am attending (Prado Dog Park), and any workers or volunteers or judges, are in no way liable for any present or future COVID-19 exposure incurred at any time by any person, in attendance or not in attendance, during or after this event.

The following person(s) will be designated to release/catch my dog at the event: \_\_\_\_\_

PRINT NAME: \_\_\_\_\_

SIGNATURE: \_\_\_\_\_

Date: \_\_\_\_\_

ALL FIELDS MUST BE FILLED OUT AND RETURNED WITH ENTRY FORMS FOR THE ENTRY TO BE COMPLETE

CCA / OCRRC PROCEDURES We will follow State and local guidelines.

1. All participant will wear facial coverings over nose and mouth and maintain social distancing of 6 feet.
2. Please bring your own food, water and shade for yourself and your dogs. None will be available at the trial.
3. We ask that you park 6 feet away from each other.
4. Roll Call will be done at everyone's car, instead of at the secretary's table area. The roll call committee will wear gloves and facial coverings. We will ask the owners of females to wipe their own dogs and show the inspection committee the tissue.
5. Wickets will be wiped down after each dog is measured.
6. We will have instant hand sanitizer and wet wipes in several locations for your use.
7. Huntmasters will stand 6 feet from the dogs after inspecting blankets and slip leads.
8. Dogs may be run in braces , at the discretion of the club, to ensure social distancing at the line and will be 6 feet apart.
9. Practice social distancing the best you can. Please act responsibly.
10. We will be posting the draws and scores for each breed separately to allow for ease of social distancing, and will post them on the So Cal Coursing FB page.
11. Above all, have fun with your dogs and be safe!!

OFFICIAL AMERICAN SIGHTHOUND FIELD ASSOCIATION ENTRY FORM

CALIFORNIA COURSING ASSOCIATION

SAT NOV 28, 2020

Early entries close on NOV 25, 2020 at 8pm at FTS' residence

Early entries: \$20 1st hound, \$17 2nd hound; Late Entry Fee \$25

Make checks payable in US funds to California Coursing Association

**JENNIFER GYSLER, FTS, PO BOX 720249, Pinon Hills, CA 92372**

Fee Paid \_\_\_\_\_ The Field Secretary cannot accept conditional, unsigned, incomplete or unpaid entries; please check your completed entry carefully.

Breed: SW	Call Name:	
Registered Name of Hound:		
Stake: <input type="checkbox"/> Open <input type="checkbox"/> FCH <input type="checkbox"/> Veteran <input type="checkbox"/> Single <input type="checkbox"/> Limited	Additional Stakes <input type="checkbox"/> Kennel <input type="checkbox"/> Breeder <input type="checkbox"/> Bench	
Registration Number: (please write in registering body before number)		
<input type="checkbox"/> If possible, please separate my hounds	Date of Birth:	Sex: <input type="checkbox"/> Dog <input type="checkbox"/> Bitch
Name of actual owner(s):		
Address:		Phone:
City:	State:	Zip:
E-mail (Optional)	(Optional) Region of Residence:	
Emergency Contact Name and Phone (Optional)		
<input type="checkbox"/> Check if this is the first ASFA trial for this hound. Attach a Hound Certification or waiver if entered in Open, Veterans, Limited.		
<input type="checkbox"/> Check if this is a first-time entry, a copy of the official Registration of this hound must accompany this entry unless NGA.		
<input type="checkbox"/> Check if any information has changed since the last ASFA trial entry. Regarding _____		
<input type="checkbox"/> Check if this hound has been dismissed within the last 6 trials entered. Must be marked in order to qualify for a "clean" trial requirement.		

I CERTIFY that I am the actual owner of this dog, or that I am the duly authorized agent of the actual owner whose name I have entered above. In consideration of the acceptance of this entry and the opportunity to have this dog judged and to win prize money, ribbons, or trophies, I (we) agree to abide by the rules and regulations of the American Sighthound Field Association in effect at the time of this lure field trial, and by any additional rules and regulations appearing in the premium list for this lure field trial. I (we) agree that the club holding this lure field trial has the right to refuse this entry for cause, which the club shall deem to be sufficient. I (we) agree to hold this club, its members, directors, governors, officers, agents or other functionaries, any employees of the aforementioned parties and the owner(s) of the trial premises or grounds harmless from any claim for loss or injury which may be alleged to have been caused directly or indirectly to any person or thing by the act of this dog while in or upon the lure field trial premises or grounds or near any entrance thereto and I (we) personally assume all responsibility and liability for any such claim, and I (we) further agree to hold the aforementioned parties harmless from any claim loss of this dog by disappearance, theft damage or injury be caused or alleged to be caused by the negligence of the club or any of the aforementioned parties or by the negligence of any person or any other cause or causes. I (we) certify and represent that the dog entered is not a hazard to person or other dogs. This entry is submitted for acceptance of the forgoing representations and agreements.

SIGNATURE of owner or his agent  
duly authorized to make this entry \_\_\_\_\_

**Please separate the entries before submitting to FTS.**

OFFICIAL AMERICAN SIGHTHOUND FIELD ASSOCIATION ENTRY FORM

CALIFORNIA COURSING ASSOCIATION

SUN NOV 29, 2020

Early entries close on NOV 25, 2020 at 8pm at FTS' residence

Early entries: \$20 1st hound, \$17 2nd hound; Late Entry Fee: \$25

Make checks payable in US funds to California Coursing Association

**JENNIFER GYSLER, FTS, PO BOX 720249, Pinon Hills, CA 92372**

Fee Paid \_\_\_\_\_ The Field Secretary cannot accept conditional, unsigned, incomplete or unpaid entries; please check your completed entry carefully.

Breed: SW	Call Name:	
Registered Name of Hound:		
Stake: <input type="checkbox"/> Open <input type="checkbox"/> FCH <input type="checkbox"/> Veteran <input type="checkbox"/> Single <input type="checkbox"/> Limited	Additional Stakes <input type="checkbox"/> Kennel <input type="checkbox"/> Breeder <input type="checkbox"/> Bench	
Registration Number: (please write in registering body before number)		
<input type="checkbox"/> If possible, please separate my hounds	Date of Birth:	Sex: <input type="checkbox"/> Dog <input type="checkbox"/> Bitch
Name of actual owner(s):		
Address:		Phone:
City:	State:	Zip:
E-mail (Optional)	(Optional) Region of Residence:	
Emergency Contact Name and Phone (Optional)		
<input type="checkbox"/> Check if this is the first ASFA trial for this hound. Attach a Hound Certification or waiver if entered in Open, Veterans, Limited.		
<input type="checkbox"/> Check if this is a first-time entry, a copy of the official Registration of this hound must accompany this entry unless NGA.		
<input type="checkbox"/> Check if any information has changed since the last ASFA trial entry. Regarding _____		
<input type="checkbox"/> Check if this hound has been dismissed within the last 6 trials entered. Must be marked in order to qualify for a "clean" trial requirement.		

I CERTIFY that I am the actual owner of this dog, or that I am the duly authorized agent of the actual owner whose name I have entered above. In consideration of the acceptance of this entry and the opportunity to have this dog judged and to win prize money, ribbons, or trophies, I (we) agree to abide by the rules and regulations of the American Sighthound Field Association in effect at the time of this lure field trial, and by any additional rules and regulations appearing in the premium list for this lure field trial. I (we) agree that the club holding this lure field trial has the right to refuse this entry for cause, which the club shall deem to be sufficient. I (we) agree to hold this club, its members, directors, governors, officers, agents or other functionaries, any employees of the aforementioned parties and the owner(s) of the trial premises or grounds harmless from any claim for loss or injury which may be alleged to have been caused directly or indirectly to any person or thing by the act of this dog while in or upon the lure field trial premises or grounds or near any entrance thereto and I (we) personally assume all responsibility and liability for any such claim, and I (we) further agree to hold the aforementioned parties harmless from any claim loss of this dog by disappearance, theft damage or injury be caused or alleged to be caused by the negligence of the club or any of the aforementioned parties or by the negligence of any person or any other cause or causes. I (we) certify and represent that the dog entered is not a hazard to person or other dogs. This entry is submitted for acceptance of the forgoing representations and agreements.

SIGNATURE of owner or his agent  
duly authorized to make this entry \_\_\_\_\_

**Please separate the entries before submitting to FTS.**

**AMERICAN SIGHTHOUND FIELD ASSOCIATION  
HOUND CERTIFICATION**

**Rule effective October 1, 1994: Ch. V, Sec. 4 (a) OPEN STAKE:** *To be eligible to enter the open stake, a hound must have been certified by a licensed judge within the year preceding the closing date for the entry or have previously competed in the Open Stake. This eligibility requirement also applies to a hound entered in the Limited or Veteran Stake, which has not competed in Open previously. Please complete this portion of this form and attach it to the entry form for the hound's first entry, including an entry for a Fun Trial.*

Registered Name of Hound: \_\_\_\_\_

Registration Number: \_\_\_\_\_ Breed: \_\_\_\_\_

Registered Owner's Name: \_\_\_\_\_

I hereby certify that on (date) \_\_\_\_\_, the above named hound completed a lure course of at least 500 yards, running with another hound of the same breed (or another breed with a similar running style). During the course the above named hound showed no inclination to interfere with the other hound. I further certify that I am a licensed judge for the ASFA.

Name of Licensed Judge: \_\_\_\_\_

Signature: \_\_\_\_\_ Date: \_\_\_\_\_

I hereby certify that the hound running in the certification course is the hound identified above and that information provided on this form is true and correct.

Signature: \_\_\_\_\_ Date: \_\_\_\_\_

Owner or Authorized Agent of Hound

This certification form must be attached to the entry form the first time this hound is entered in an open, limited, or veteran stake. Any hound entered in open, limited, or veteran (as a first time entered hound), which has not been certified, shall be declared ineligible by the records coordinator and shall forfeit any points and placements awarded.

**PLEASE RETAIN A COPY FOR YOUR RECORDS.**

**AMERICAN SIGHTHOUND FIELD ASSOCIATION  
HOUND CERTIFICATION WAIVER**

**Waiver of Requirement:** *This requirement will be waived for a hound that has earned a lure coursing or racing title from another recognized organization, if such title requires competition, and if a waiver for such title has been approved by the ASFA, or a CKC Hound Certification Form. If your hound qualifies for a waiver, complete this portion of this form and attach it to your entry form. Proof of waivers must accompany this certification form.*

Registered Name of Hound: \_\_\_\_\_

Registration Number: \_\_\_\_\_ Breed: \_\_\_\_\_

Registered Owner's Name: \_\_\_\_\_

**CKC:** FCH

**AKC:** QC SC FC

Hound Certification previously submitted.

I hereby certify that the hound identified above has completed the requirements for the title indicated above (or that the required Certification was previously submitted) and that the information provided on this form is true and correct.

Signature: \_\_\_\_\_ Date: \_\_\_\_\_

Owner or Authorized Agent of Hound

**AMERICAN SIGHTHOUND FIELD ASSOCIATION  
HOUND CERTIFICATION**

**Rule effective October 1, 1994: Ch. V, Sec. 4 (a) OPEN STAKE:** *To be eligible to enter the open stake, a hound must have been certified by a licensed judge within the year preceding the closing date for the entry or have previously competed in the Open Stake. This eligibility requirement also applies to a hound entered in the Limited or Veteran Stake, which has not competed in Open previously. Please complete this portion of this form and attach it to the entry form for the hound's first entry, including an entry for a Fun Trial.*

Registered Name of Hound: \_\_\_\_\_

Registration Number: \_\_\_\_\_ Breed: \_\_\_\_\_

Registered Owner's Name: \_\_\_\_\_

I hereby certify that on (date) \_\_\_\_\_, the above named hound completed a lure course of at least 500 yards, running with another hound of the same breed (or another breed with a similar running style). During the course the above named hound showed no inclination to interfere with the other hound. I further certify that I am a licensed judge for the ASFA.

Name of Licensed Judge: \_\_\_\_\_

Signature: \_\_\_\_\_ Date: \_\_\_\_\_

I hereby certify that the hound running in the certification course is the hound identified above and that information provided on this form is true and correct.

Signature: \_\_\_\_\_ Date: \_\_\_\_\_

Owner or Authorized Agent of Hound

This certification form must be attached to the entry form the first time this hound is entered in an open, limited, or veteran stake. Any hound entered in open, limited, or veteran (as a first time entered hound), which has not been certified, shall be declared ineligible by the records coordinator and shall forfeit any points and placements awarded.

**PLEASE RETAIN A COPY FOR YOUR RECORDS.**

**AMERICAN SIGHTHOUND FIELD ASSOCIATION  
HOUND CERTIFICATION WAIVER**

**Waiver of Requirement:** *This requirement will be waived for a hound that has earned a lure coursing or racing title from another recognized organization, if such title requires competition, and if a waiver for such title has been approved by the ASFA, or a CKC Hound Certification Form. If your hound qualifies for a waiver, complete this portion of this form and attach it to your entry form. Proof of waivers must accompany this certification form.*

Registered Name of Hound: \_\_\_\_\_

Registration Number: \_\_\_\_\_ Breed: \_\_\_\_\_

Registered Owner's Name: \_\_\_\_\_

**CKC:** FCH

**AKC:** QC SC FC

Hound Certification previously submitted.

I hereby certify that the hound identified above has completed the requirements for the title indicated above (or that the required Certification was previously submitted) and that the information provided on this form is true and correct.

Signature: \_\_\_\_\_ Date: \_\_\_\_\_

Owner or Authorized Agent of Hound

OFFICIAL AMERICAN SIGHTHOUND FIELD ASSOCIATION  
LCI ENTRY FORM

CALIFORNIA COURSING ASSOCIATION

SAT NOV 28, 2020 Day of \$25, accepted up to 8:30am

Pre-entries close on NOV 25, 2020 at 8pm at FTS' residence

Entries: \$20 1st hound, \$10 2nd hound

Make checks payable in US funds to California Coursing Association

**J GYSLER, FTS, P.O. Box 720249, Pinon Hills, CA 92372**

Fee Paid \_\_\_\_\_ The Field Secretary cannot accept conditional, unsigned, incomplete or unpaid entries; please check your completed entry carefully.

Breed:		Call Name:	
Registered Name of dog:			
Stake: <input type="checkbox"/> LCI-Small <input type="checkbox"/> LCI-Large <input type="checkbox"/> LCI-Sighthound Mix <input type="checkbox"/> Open <input type="checkbox"/> Senior <input type="checkbox"/> Veteran			
Registration Number: (please write in registering body before number)			
Date of Birth:		Sex: <input type="checkbox"/> Dog <input type="checkbox"/> Bitch	
Name of actual owner(s):			
Address:		Phone:	
City:		State:	Zip:
E-mail		(Optional) Region of Residence:	
Emergency Contact Name and Phone (Optional)			
<input type="checkbox"/> Check if this is a first-time entry, a copy of the official Registration of this hound must accompany this entry. (i.e., AKC Registration form, PAL registration, Canine Partner, etc.)			
<input type="checkbox"/> Check if any information has changed since the last ASFA trial entry. Regarding _____			

I CERTIFY that I am the actual owner of this dog, or that I am the duly authorized agent of the actual owner whose name I have entered above. In consideration of the acceptance of this entry and the opportunity to have this dog judged and to win prize money, ribbons, or trophies, I (we) agree to abide by the rules and regulations of the American Sighthound Field Association in effect at the time of this lure field trial, and by any additional rules and regulations appearing in the premium list for this lure field trial. I (we) agree that the club holding this lure field trial has the right to refuse this entry for cause, which the club shall deem to be sufficient. I (we) agree to hold this club, its members, directors, governors, officers, agents or other functionaries, any employees of the aforementioned parties and the owner(s) of the trial premises or grounds harmless from any claim for loss or injury which may be alleged to have been caused directly or indirectly to any person or thing by the act of this dog while in or upon the lure field trial premises or grounds or near any entrance thereto and I (we) personally assume all responsibility and liability for any such claim, and I (we) further agree to hold the aforementioned parties harmless from any claim loss of this dog by disappearance, theft damage or injury be caused or alleged to be caused by the negligence of the club or any of the aforementioned parties or by the negligence of any person or any other cause or causes. I (we) certify and represent that the dog entered is not a hazard to person or other dogs. This entry is submitted for acceptance of the forgoing representations and agreements.

**SIGNATURE** of owner or his agent  
duly authorized to make this entry \_\_\_\_\_

**Please separate the entries before submitting to FTS.**

OFFICIAL AMERICAN SIGHTHOUND FIELD ASSOCIATION  
LCI ENTRY FORM

CALIFORNIA COURSING ASSOCIATION

SUN NOV 29, 2020 Day of \$25, accepted up to 8:30am

Pre-Entries close on NOV 25, 2020 at 8pm at FTS' residence

Entries: \$20 1st hound, \$10 2nd hound

Make checks payable in US funds to California Coursing Association

**J GYSLER, FTS, P.O. Box 720249, Pinon Hills, CA 92372**

Fee Paid \_\_\_\_\_ The Field Secretary cannot accept conditional, unsigned, incomplete or unpaid entries; please check your completed entry carefully.

Breed:		Call Name:	
Registered Name of dog:			
Stake: <input type="checkbox"/> LCI-Small <input type="checkbox"/> LCI-Large <input type="checkbox"/> LCI-Sighthound Mix <input type="checkbox"/> Open <input type="checkbox"/> Senior <input type="checkbox"/> Veteran			
Registration Number: (please write in registering body before number)			
Date of Birth:		Sex: <input type="checkbox"/> Dog <input type="checkbox"/> Bitch	
Name of actual owner(s):			
Address:		Phone:	
City:		State:	Zip:
E-mail		(Optional) Region of Residence:	
Emergency Contact Name and Phone (Optional)			
<input type="checkbox"/> Check if this is a first-time entry, a copy of the official Registration of this hound must accompany this entry. (i.e., AKC Registration form, PAL registration, Canine Partner, etc.)			
<input type="checkbox"/> Check if any information has changed since the last ASFA trial entry. Regarding _____			

I CERTIFY that I am the actual owner of this dog, or that I am the duly authorized agent of the actual owner whose name I have entered above. In consideration of the acceptance of this entry and the opportunity to have this dog judged and to win prize money, ribbons, or trophies, I (we) agree to abide by the rules and regulations of the American Sighthound Field Association in effect at the time of this lure field trial, and by any additional rules and regulations appearing in the premium list for this lure field trial. I (we) agree that the club holding this lure field trial has the right to refuse this entry for cause, which the club shall deem to be sufficient. I (we) agree to hold this club, its members, directors, governors, officers, agents or other functionaries, any employees of the aforementioned parties and the owner(s) of the trial premises or grounds harmless from any claim for loss or injury which may be alleged to have been caused directly or indirectly to any person or thing by the act of this dog while in or upon the lure field trial premises or grounds or near any entrance thereto and I (we) personally assume all responsibility and liability for any such claim, and I (we) further agree to hold the aforementioned parties harmless from any claim loss of this dog by disappearance, theft damage or injury be caused or alleged to be caused by the negligence of the club or any of the aforementioned parties or by the negligence of any person or any other cause or causes. I (we) certify and represent that the dog entered is not a hazard to person or other dogs. This entry is submitted for acceptance of the forgoing representations and agreements.

**SIGNATURE** of owner or his agent  
duly authorized to make this entry \_\_\_\_\_

**Please separate the entries before submitting to FTS.**

